

Ripaille Castle



Your wedding
reception in an exceptional site

Conditions as of March 1, 2021

Fondation Ripaille
74200 Thonon-les-Bains
tél. 04 50 26 64 44
www.ripaille.fr



FONDATION RIPAILLE

Your Castle for an unforgettable celebration

*You too can come and feast at Ripaille
like the first Duke of Savoy*



Enjoy the charms of Ripaille by hiring rooms in the castle.

In a discreet, chic and exceptional setting, the Ripaille Foundation team is here to welcome you every day of the year.



The Ripaille Foundation

Through a donation by Mrs Elisabeth Necker-Engel, Amédée VIII's Castle has since 1976 been the seat of a foundation recognized as being of public utility, whose aim is to preserve and highlight for the public the historical, artistic and natural heritage of Ripaille and to make this site a place promoting a better relationship between man and his environment.

All financial contributions are used to maintain the castle buildings and support the Ripaille Foundation's development projects.



Reception facilities

Use of the Amédée VIII pavilion with different options:

- **The salle des Ambassadeurs** on the ground floor (120m²), with direct access to a lawn (1600m²) accommodating 120.

- **The first floor reception rooms**

- Salon Amédée VIII (seating 60)

- Hall and vaulted room (seating 50)

Capacity is given for a seated meal. The maximum capacity allowed is 500.

For some events it is possible to create extra space by installing a **marquee**.



Other facilities:

- **A free car-park** with 100 spaces in front of the castle. Coach parking in the driveway.

- **Le Grand Jardin** is south facing, with mountain views.

Caterers

Only caterers commissioned by the foundation are allowed at the castle.

List on request

Entertainment

Guided visit and wine-tasting

It is possible to book a private visit with a qualified Foundation guide and to arrange for tasting wines from the estate.

Details on request.

Music

You can invite musical groups of your choice. The music stops at 4 am. All entertainment is placed under the responsibility of the client in accordance with our rules of procedure (page 5).

The person in charge should contact the Foundation 8 days before the reception.



Conditions of Hire

The castle buildings are listed historical monuments and the Ripaille Foundation organizes mainly visits open to the general public, which means prior contact with the Foundation is essential. In order to best meet your requirements, a visit of the reception areas is mandatory, by appointment.

Reservation, invoicing and guarantee.

A firm booking of the premises will only be registered on payment of a deposit of 50% of the basic price. In the event of cancellation by the hirer, this deposit will not be refunded.

The balance of the foreseeable amount is to be paid to the Ripaille Foundation one week before your reception. The final invoice, including any possible supplements will be sent after the reception. The balance is to be settled upon receipt of the invoice.

Decoration of the venue and the banquet cannot be arranged by the Foundation.

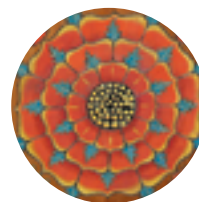

Tariffs

All rates displayed include VAT

Provision of facilities from 6pm to 5am

Up to 50 guests: 1500 €

From 51 to 100 guests: 2700 €

Over 100 guests: 15 € extra per guest

Rate low season

25 % off for a wedding planned from novembre to march

Security service

Mandatory fixed fee: 210 €

(surveillance and closing of the castle)

Maid service

Mandatory fixed fee : 210 €

Option sound and video

- Sound and video projector: 250€
(MIPRO MA 705 on stand + microphone)

- Hire of piano: 250€

Available only on the first floor in the hall,
providing a professional pianist is to play.

Piano tuning at your expense.

A guarantee of 1500€ per evening is required
(to be deposited one week before the reception).

In the event of damage to the facilities and premises preventing full opening to the public, Ripaille Foundation reserves the right to take this guarantee.

Rules of procedure

As the owner of Ripaille Castle, the Foundation aims to animate, restore and conserve the site. Compliance with the rules is thus essential.



Responsibility and restrictions

In accordance with the Evin Act of Parliament and for heritage preservation reasons, the interior of the castle is a **non-smoking area**.

Objects deposited by the hirer in the castle. The provision of rooms in the castle for the deposit of any objet or material to be used by the hirer does not entail any commitment of supervision for the Ripaille Foundation. The foundation declines any responsibility for what could happen to these objects or this material.

Vehicles

The Ripaille foundation is not responsible for vehicles parked within the castle grounds and recommends that owners do not leave any documents or objects in full view inside the vehicle. Use of a security company for car park surveillance is recommended. No vehicle is allowed in the courtyard of the castle unless special permission has been given by the Foundation.

Entertainment

Fireworks are strictly forbidden. No music is allowed outdoors after 10pm. Access to the lawn next to the Salle des Ambassadeurs and the Jardin des Cellules is allowed up to 10pm.

An orchestra and/or sound system can only be set up in the Salle des Ambassadeurs, the exact location being determined in consultation with the management.

The volume of the sound system should be set to a reasonable listening level that is not audible on the other side of the main courtyard, throughout the evening, so as to respect the neighbourhood. The person in charge of the surveillance of the Castle may request you to lower the sound, if he deems it necessary.



Decoration - Installation Secular Ceremony

Only floral decoration is allowed on the tables. Any specific installation (DJ, music, decoration) is subject to the authorization of the Ripaille Foundation.

It is possible to organize a secular ceremony in the gardens of the castle (possibility of folding on the first floor in case of bad weather) from 5 pm on the wedding day. The installations or decorations of the spaces of the secular ceremony are subject to authorization by the Foundation and can be done the day before the wedding between 2 am and 5 pm. Specific equipment installations (chairs and tables) are the responsibility of the customers.

Movement of vehicles and guests

Only service vehicles will be able to enter the courtyard of honour. Guests must respect the limits marked by barriers, stay Castle side and avoid moving around after 10pm. Guests are to leave as quietly as possible.



Simplified plans of Ripaille Castle

Rooms available for hire

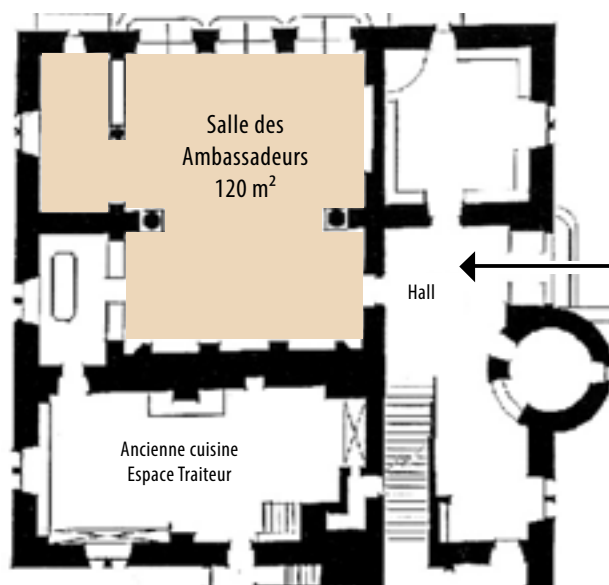

The ground floor

La salle des Ambassadeurs - seating 120



The 1st floor

Two rooms + hall - seating 110



**CONTACT &
RÉSERVATION**

Fondation Ripaille
Château de Ripaille
83, av. de Ripaille
74200 Thonon-les-Bains
Tél. +33 4 50 26 64 44
location@ripaille.fr
www.ripaille.fr